



HDMI Wireless Extender with UNIdirectional IR Control (100 m)

Model: WI-HD-100



INTRODUCTION

This product is based on the H.265 standard solution, which transmits a HD source signal to an HD display device. It wirelessly extends the distance between the encoder and decoder up to 100 meters (in an open environment without Wi-Fi interference). It supports one-way IR control and provides configurable high quality low bandwidth H.265 Compressed video (resolution up to 1080P@60Hz) This wireless extender can easily realize the wireless transmission of HD audio and video signals in the same environment, thus eliminating the tedious work of burying wire in the early stage of wired transmission.

FEATURES

- Supports HDMI 1.3, HDCP 1.4 and DVI 1.0;
- Transmit a HD source signal wirelessly to a HD display device;
- It has one-way IR transmission function;
- HDMI wireless transmission range up to 100 meters (open environment without Wi-Fi interference);
- Video resolution up to 1080P@60Hz;
- Audio formats support LPCM 2.0CH 32KHz/ 44.1khz /48KHz;
- Using H.265 high performance codec technology;
- The end-to-end delay is less than 120 ms;
- Reasonable design, easy to install.



DIAGRAM

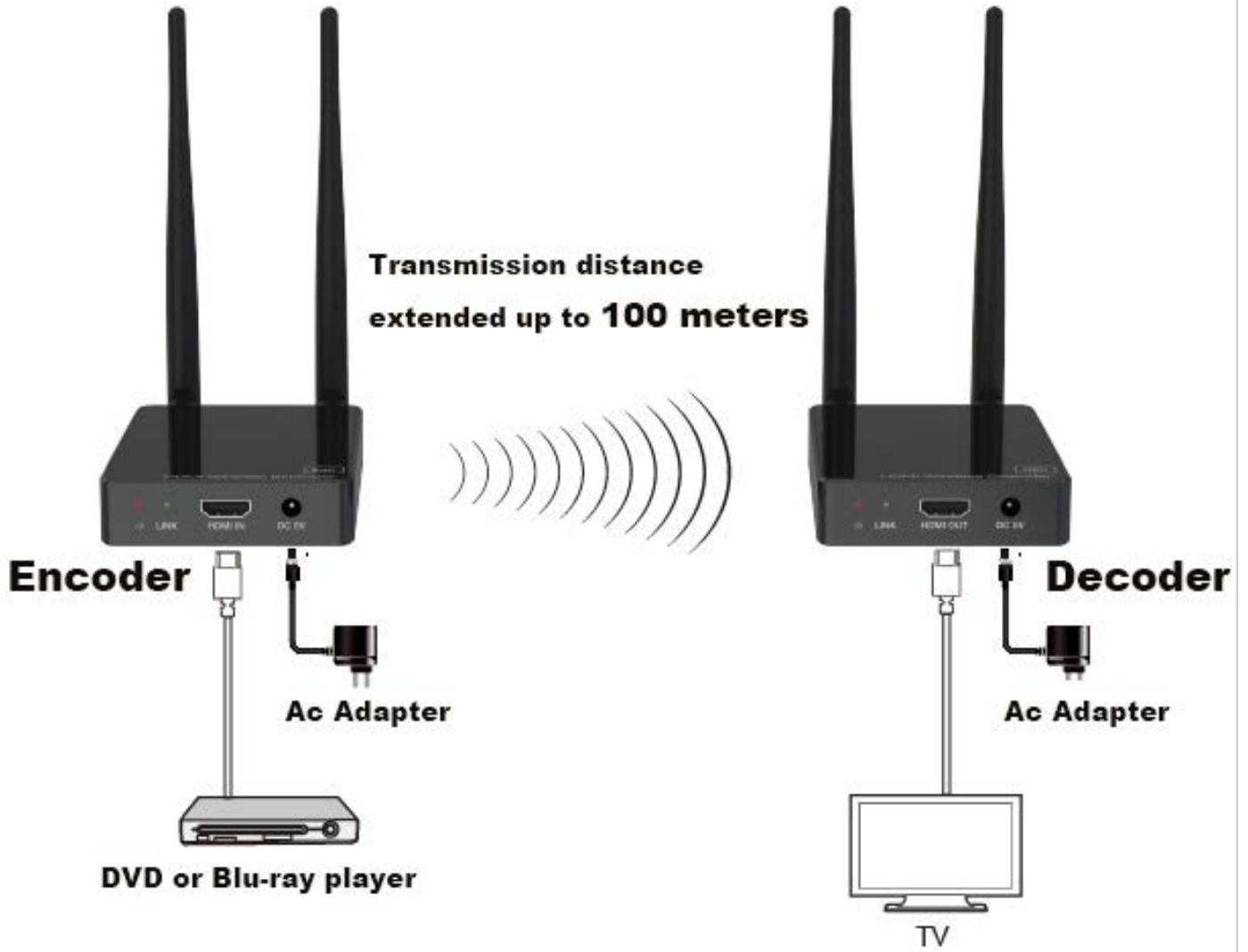

APPLICATION

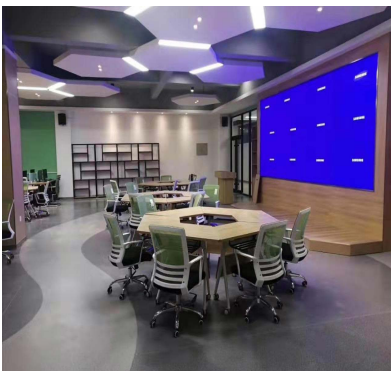



SPECIFICATIONS

Specification	
HDMI compatible	HDMI 1.3
HDCP compatible	HDCP 1.4
Video bandwidth	6.75Gbps
Video Resolution	1080p, 1080i, 720p, 720i, 480p, 480i, 1920×1080 @60hz, 1920×1200@60Hz(Max)
Color Space	RGB / YCbCr 4:4:4, YCbCr 4:2:2, YUV 4:2:0
Color Depth	8/10/12-bit (1080P60Hz)
HDMI audio format	LPCM 2.0CH 32KHz/44.1KHz/48KHz
Electrostatic Protection	±8kV (kV) , ±4kV (Contact discharge)
Connect	
Encoder	Input: 1×HDMI Type A [19-pin Receptacle] Output: 1×IR OUT [3.5mm Stereo Mini-jack] 2×WiFi OUT [WiFi antenna] Control: 1×SERVICE [Mini-USB, Scalable Link Interface]
Decoder	Input: 1×IR IN [3.5mm Stereo Mini-jack] 2×WiFi IN [WiFi antenna] Output: 1×HDMI Type A [19-pin Receptacle] Control: 1×SERVICE [Mini-USB, Scalable Link Interface]
Fuselage	
Housing	Plastic Enclosure
Color	Black
Size	Encoder/Decoder: 98mm [L]x 76mm [W] x 21mm [H]
Weight	Encoder/Decoder: 100g
Power supplies	Input: AC 100~240V 50/60Hz Output: DC 5V/1A
Power Consumption	Encoder: 2.25W, Decoder: 1.8W
Operating temperature	0°C ~ 40°C / 32°F ~ 104°F
Storage temperature	-20°C ~ 60°C / -4°F ~ 140°F
Relative humidity	20~90% RH (No condensation)
Resolution/line length	1080P60Hz - Meter
HDMI IN / OUT	15m
Advanced high-speed HDMI cable is recommended.	